

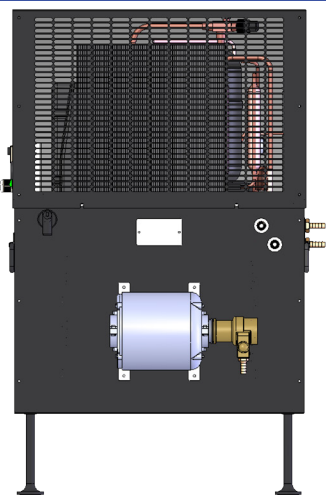

# Extra 1/2



### Standard Features

- ▶ Easy to Install, service and maintain
- ▶ Large condenser for warm ambient conditions
- ▶ Digital thermostat
- ▶ High-Efficiency evaporator shaped for optimal use of the glycol bath

### Specifications

Name	Unit	Extra 1/2
Part		EG-1/2P
Maximum Distance	FT	250'
Capacity, (evap 20 F)	BTU/HR	3900
Tank Capacity	Gal	18
Dedicate Circuit	AMP	20
Voltage	Voltz/HZ	115/60
Compressor Power	H/P	1/2
Thermostat	Type	Dixell
Pump Type		Procon-100 gal/hr
Refrigerant	Type	R134a
Dimensions	Width, in	28
	Depth, in	23
	Height, in	30
Weight (net/gross)	Lbs	176/154
Clearance at least		12" around unit
Glycol Mixture	%	40% Glycol, 60% Water

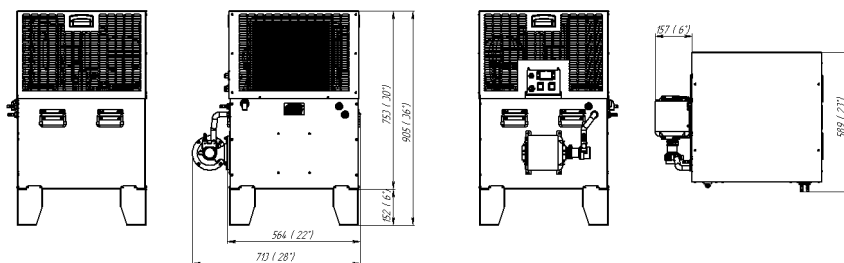
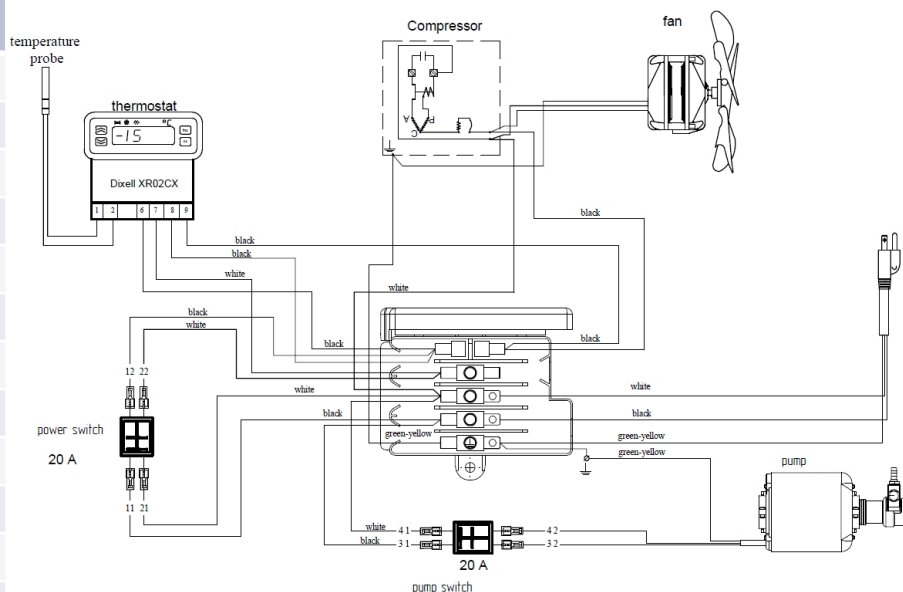

# Extra 1/2

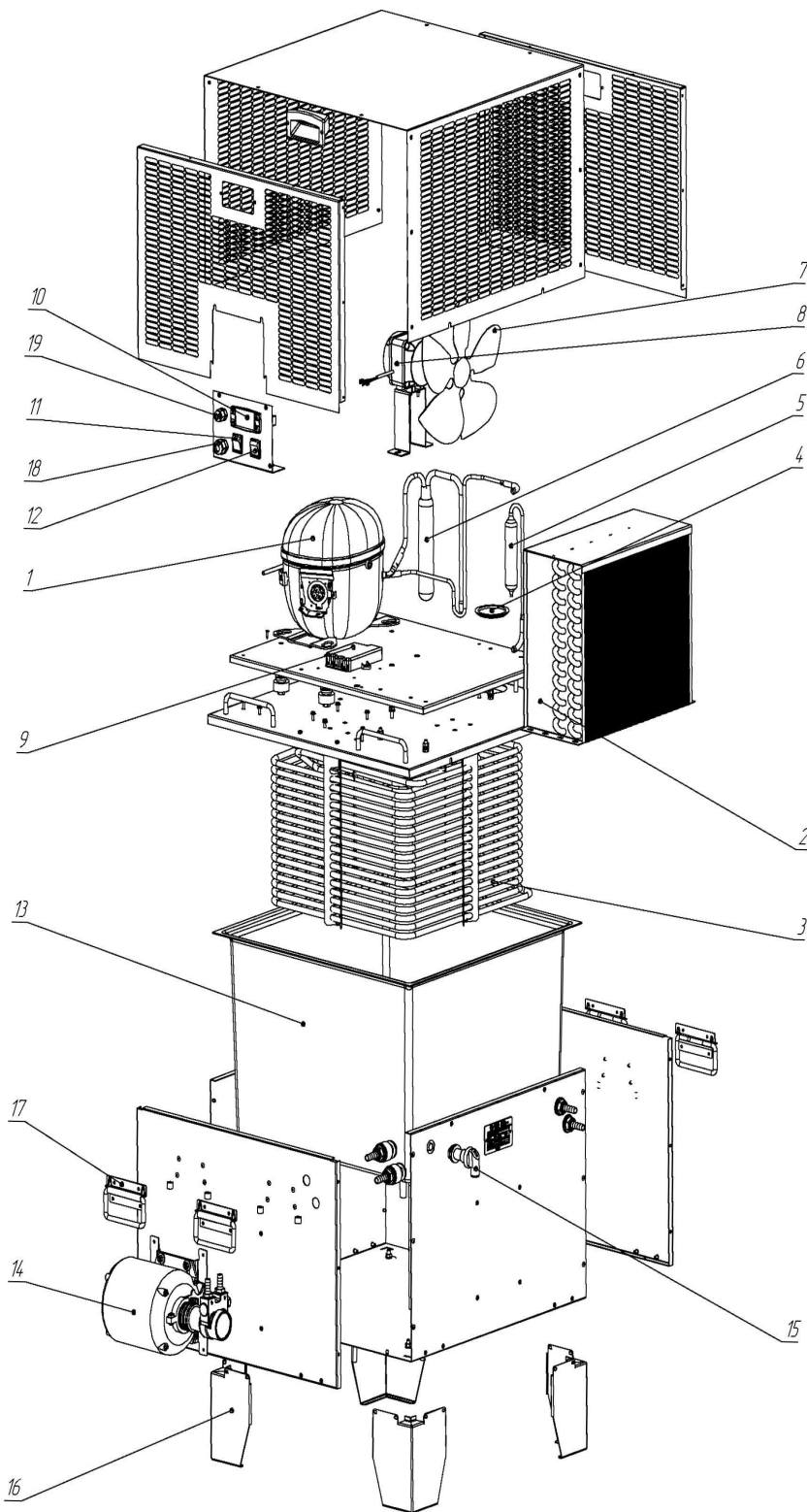

1	Compressor "Tecumseh" CAJ4492Y (115/60)
2	Air Condenser KARYER B-16804
3	Evaporator
4	Cap
5	Drier- filter "BVB" GR-30
6	Accumulator 30x200
7	Impeller $\varnothing 254$ , $\alpha=28^\circ$
8	Electric motor "ELCO" NU 25-45-2/2004 (115V-50/60 Hz)
9	Terminal block "ITW Elettrogibi" PA104
10	Thermostat "Dixell" XR02CX-4N0F1
11	Power switch "Arcoelectric" C6053ALNBN RED
12	Power switch "Aroelectric" C6053AL GREEN
13	Glycol Bath
14	Glycol pump "Procon" 102A080F11BA and motor "Marathon" 5KH32FN5586MX
15	Overflow
16	Foot
17	Handle
18	Cable clamp PG 13.5
19	Cable clamp PG 9
20	Electric shoe "Junior"

